

HYBRID OVATION™ II 4/5/6

*Component Systems
Installation Guide*



www.morelhifi.com

PACKAGE CONTENT

4" HYBRID OVATION WOOFER



X2



X2



X6



X8



X2



X8



X8

5" HYBRID OVATION WOOFER



X2



X2



X2



X8



X8

6" HYBRID OVATION WOOFER



X2



X2



X2



X8



X8

CROSSOVER ACCUSET MX-22.4



X2



X2



X6



X6

TWEETER MT-22



X2



X2



X2



X2



X2



X2



X4



X2



M3

GRILL OPTION

SURFACE
OPTIONS

WOOFER & CROSSOVER MOUNTING

4" UNIT MOUNTING

1

Use the screw clips in any combination, with or without the plastic frame. These clips can be used either way up/down depending on the installation requirements.

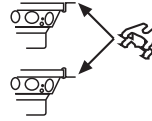

1

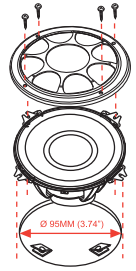

2

Use the non-screw clips to install in locations which do not require screws. Insert the clips in the small holes on the side of the loudspeaker according to your requirements.



2

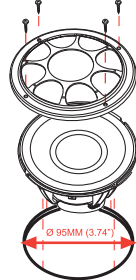

5" UNIT MOUNTING

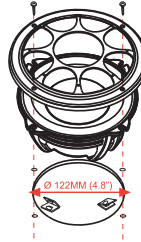

6" UNIT MOUNTING

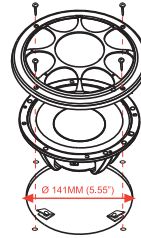

CROSSOVER MOUNTING

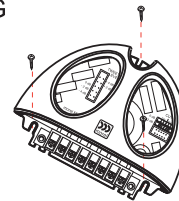

FLUSH MOUNTING

1

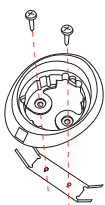

2

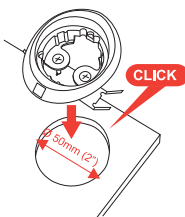

3

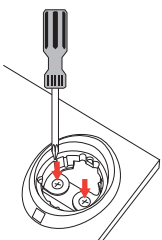

4

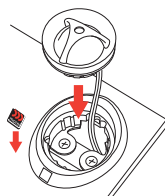

SURFACE MOUNTING

1

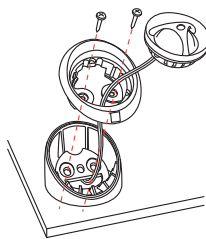

2

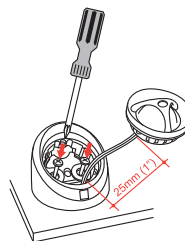

3

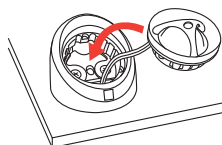

4

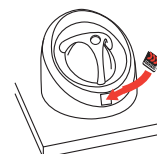

OPTION 3

1

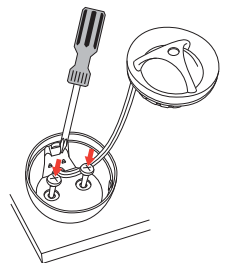

2

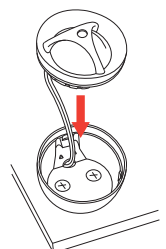

WIRING OPTION FOR ACCUSET MX-22.4 CROSSOVER

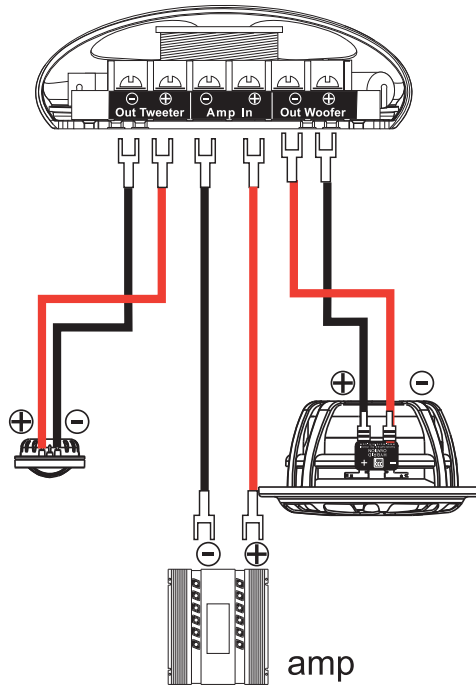

ACCUSET MX-22.4 CROSSOVER ALIGNMENT SYSTEM

Use the jumper to determine the tweeter +/- dB level

Use the jumpers to activate the tweeter protection ("protect") or cancel tweeter protection ("direct")

Use the black jumper to determine the tweeter and woofer crossover slope cut

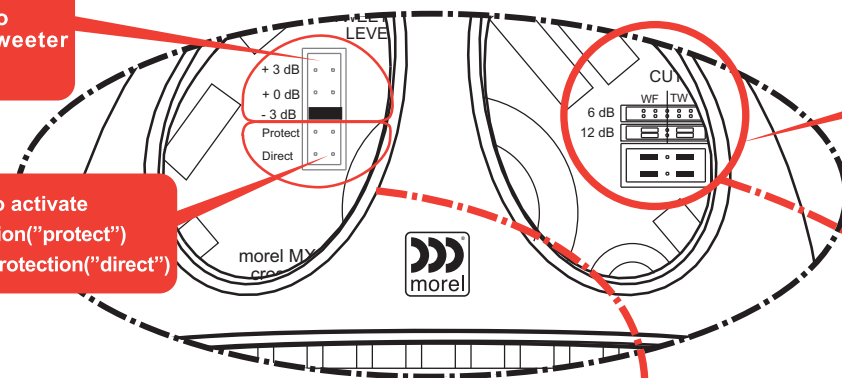

ACCUSET ALIGNMENT SYSTEM

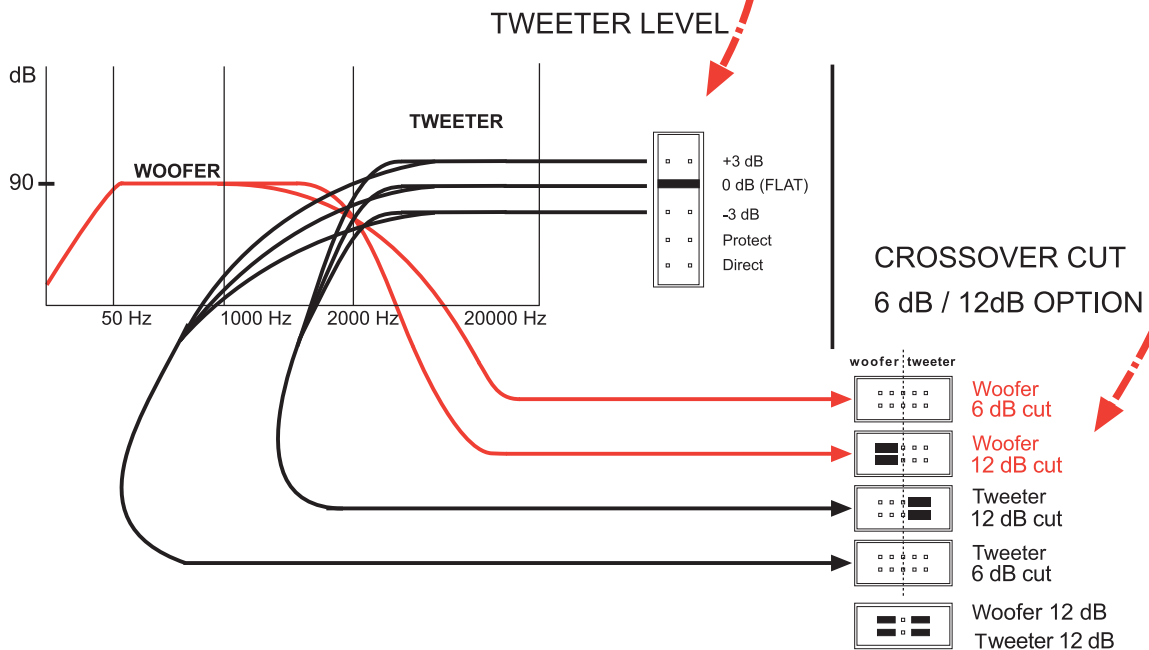

HYBRID OVATION II SPECIFICATIONS

4" SYSTEM SPECIFICATIONS

Nominal Impedance	4 Ohm
Power Handling	100W
Max. Transient Power Handling	300W
Sensitivity (2.83V/1M)	89dB
Frequency response	50-25000Hz

4" WOOFER SPECIFICATIONS

Nominal Impedance	4 Ohm
Power Handling	100W
Max. Transient Power Handling	300W
Sensitivity (2.83V/1M)	89dB
Frequency response	50-4200Hz
FS	82Hz
Voice Coil Diameter	54mm (2.125")
Voice Coil Height	10.5mm (.41")
Voice Coil type/ Former	Aluminum
Voice Coil Wire	Hexatech™ Aluminum
DC Resistance	4.2Ohm
Voice Coil Inductance @1Khz	0.34MH
Magnet system	Hybrid,Rear Vented magnet
HE- Magnetic Gap Height	5mm
B- Flux density	0.85T
BL Product/BXL	5.92
Max Linear Excursion/Xmax	5.5mm (±2.75mm)
Suspension Compliance CMS	551
Mechanical Q factor QES	0.41
Total Q Factor Q/T	0.35
QMS	2.44
Mechanical Resistance RMS	0.68KgS ¹
Moving Mass MMS	6.48gr
Equivalent Cas Air Load VAS	3.17 Liters
Effective piston area SD	64cm ²
Cone Type	One Piece Formed
Cone Material	DPC (Damped Polymer Composite)
Unit Diameter	104mm (4")
Mounting Depth	50mm (2")
Mounting Cutout	95mm (3.74") Dia.
Net Weight	0.530Kg

5" SYSTEM SPECIFICATIONS

Nominal Impedance	4 Ohm
Power Handling	120W
Max. Transient Power Handling	500W
Sensitivity (2.83V/1M)	91dB
Frequency response	40-25000Hz

5" WOOFER SPECIFICATIONS

Nominal Impedance	4 Ohm
Power Handling	120W
Max. Transient Power Handling	500W
Sensitivity (2.83V/1M)	91dB
Frequency response	35-3000Hz
FS	60Hz
Voice Coil Diameter	54mm (2.125")
Voice Coil Height	10.5mm (.41")
Voice Coil type/ Former	Aluminum
Voice Coil Wire	Hexatech™ Aluminum
DC Resistance	3.7Ohm
Voice Coil Inductance @1Khz	0.31MH
Magnet system	Hybrid,Rear Vented magnet
HE- Magnetic Gap Height	5mm
B- Flux density	1.0T
BL Product/BXL	4.33
Max Linear Excursion/Xmax	5.5mm (±2.75mm)
Suspension Compliance CMS	921
Mechanical Q factor QES	0.55
Total Q Factor Q/T	0.45
QMS	2.54
Mechanical Resistance RMS	0.52KgS ¹
Moving Mass MMS	7.0gr
Equivalent Cas Air Load VAS	10.50 Liters
Effective piston area SD	90cm ²
Cone Type	One Piece Formed
Cone Material	DPC (Damped Polymer Composite)
Unit Diameter	135mm (5.25")
Mounting Depth	60mm (2.36")
Mounting Cutout	120mm (4.72") Dia.
Net Weight	0.600Kg

6" SYSTEM SPECIFICATIONS

Nominal Impedance	4 Ohm
Power Handling	140W
Max. Transient Power Handling	600W
Sensitivity (2.83V/1M)	90dB
Frequency response	35-25000Hz

6" WOOFER SPECIFICATIONS

Nominal Impedance	4 Ohm
Power Handling	140W
Max. Transient Power Handling	600W
Sensitivity (2.83V/1M)	90dB
Frequency response	35-3000Hz
FS	60Hz
Voice Coil Diameter	54mm (2.125")
Voice Coil Height	12.0mm (0.47")
Voice Coil type/ Former	Aluminum
Voice Coil Wire	Hexatech™ Aluminum
DC Resistance	3.5Ohm
Voice Coil Inductance @1Khz	0.29MH
Magnet system	Neodymium,Rear Vented magnet
HE- Magnetic Gap Height	5mm
B- Flux density	0.9T
BL Product/BXL	4.50
Max Linear Excursion/Xmax	7.0mm (±3.5mm)
Suspension Compliance CMS	0.62
Mechanical Q factor QES	0.55
Total Q Factor Q/T	0.46
QMS	2.40
Mechanical Resistance RMS	1.74kgS ¹
Moving Mass MMS	11.40gr
Equivalent Cas Air Load VAS	12L (0.42ft ³)
Effective piston area SD	119cm ²
Cone Type	One Piece Formed
Cone Material	DPC (Damped Polymer Composite)
Unit Diameter	165.00mm (6.50")
Mounting Depth	61.00mm (2.40")
Mounting Cutout	141.00mm (5.55") Dia.
Net Weight	0.60kg

TWEETER MT-22 SPECIFICATIONS

Nominal Impedance	4 Ohm
Power Handling	110W
Max. Transient Power Handling	300W
Sensitivity (2.83V/1M)	91dB
Frequency response	1600-25000Hz
FS	950Hz
Voice Coil Diameter	28mm (1.125")
Voice Coil Height	2.2mm (.06")
Voice Coil Former	Aluminum
Voice Coil Wire	Hexatech™ Aluminum
DC Resistance	3.4Ohm
Magnet system	Neodymium
HE- Magnetic Gap Height	2mm (0.12")
Dome Type	Acuflex™
	Hand Coated Soft Dome
Unit Diameter	45mm (1.8") Dia.
Mounting Depth	20mm (0.8")
Mounting Cutout	50mm (2") Dia.

ACCUSET MX-22.4 CROSSOVER

Nominal Impedance	4 Ohm
Power Handling	200W
Crossover Point	1800Hz
Crossover Controls	Frequency Slope: Cut 6/12 dB. Tweeter Level: ±3dB Tweeter protection
Wiring Options	Standard.
Housing Material	ABS
Terminal Type	Large Screws gold plated
Net Weight	0.544 Kg

